

Township No 33 N, Range No 6 W, 2nd Mer.

PORTER TOWNSHIP

MORGAN TOWNSHIP

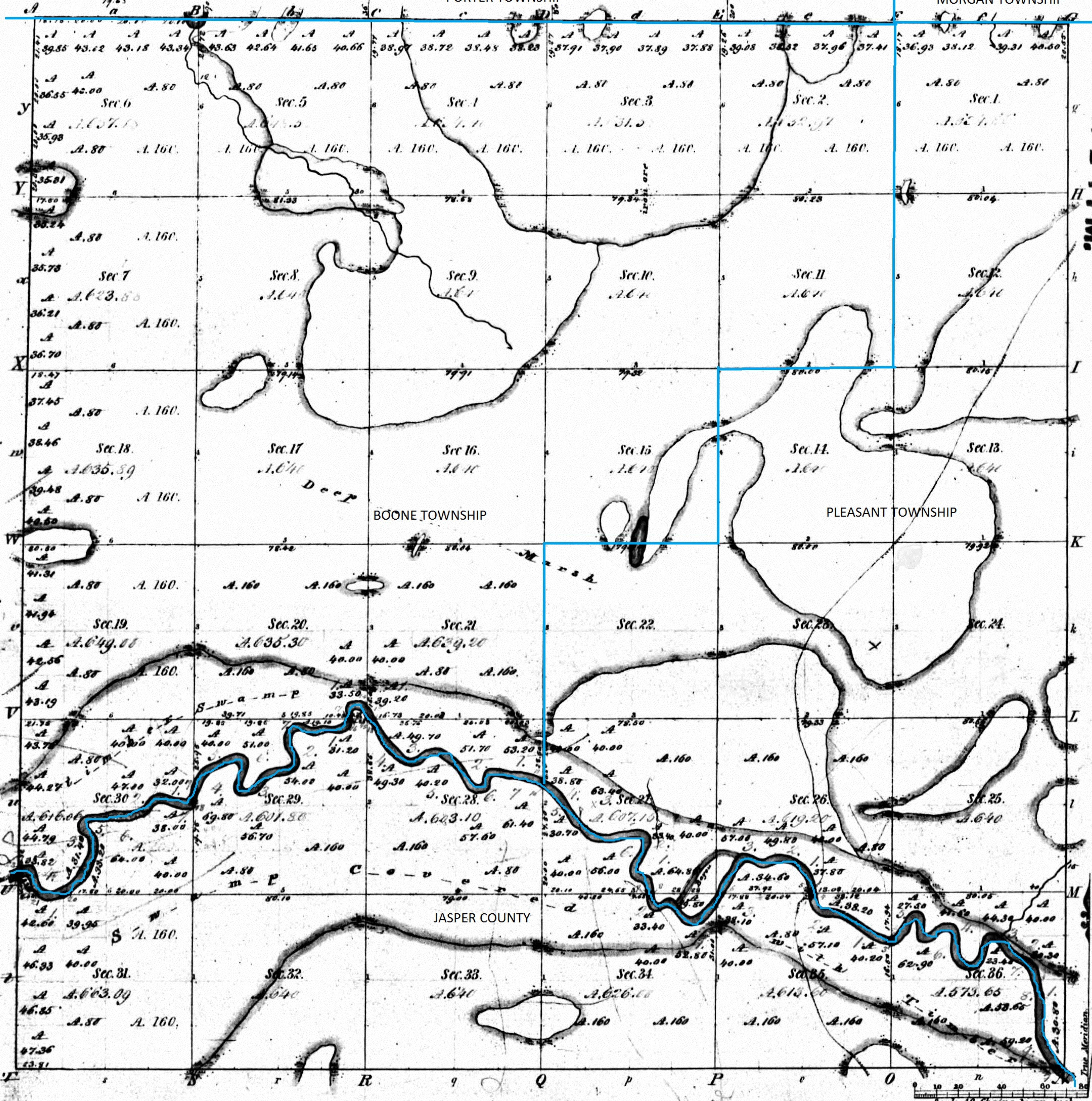

INDIANA
N & W 2 P. M.

Meanders of Kankakee River						
Poste	Courses	Ch'Lk'	Poste	Courses	Ch'Lk'	
<i>Left Bank down</i>						
1.	N57°44'	4.00	N25°0'	8.00	S42°44'	6.00
	N20°44'	5.00	North	4.00	S51°44'	2.94
	N26°44'	6.00	N30°44'	2.50	S64°44'	5.50
	N12°44'	5.50	S77°44'	4.00	N89°44'	8.51
	North	3.50	S64°44'	8.51	N55°44'	4.60
	N12°44'	2.50	N84°44'	4.00	21. N77°44'	5.50
	N2°44'	5.00	N67°44'	11.00	N45°44'	2.00
	N5°44'	9.00	N42°44'	4.00	22. S73°44'	3.90
	N60°44'	5.00	N49°44'	9.00	<i>Right Bank down</i>	
	West	4.50	N27°44'	4.00	N46°44'	5.00
	N24°44'	5.00	N39°44'	3.00	N29°44'	10.50
	N42°44'	3.00	N38°44'	5.50	N8°44'	7.50
	N49°44'	8.50	N30°44'	5.00	N37°44'	6.50
	S71°44'	3.50	N89°44'	15.00	N13°44'	8.00
	S6°44'	6.00	N67°44'	3.00	N64°44'	9.50
	S44°44'	5.00	N79°44'	2.00	N51°44'	3.50
	S77°44'	6.00	S20°44'	7.50	N37°44'	11.00
	N46°44'	9.50	S66°44'	3.00	N34°44'	7.00
	N7°44'	3.50	N68°44'	3.00	N27°44'	7.00
	N14°44'	8.00	N51°44'	5.50	S78°44'	1.50
	N59°44'	4.50	N23°44'	5.00	S38°44'	4.00
	S66°44'	3.50	N47°44'	10.50	S27°44'	5.50
	S45°44'	5.50	N66°44'	6.00	N37°44'	1.50
	S78°44'	2.50	S47°44'	8.00	N71°44'	6.00
	N37°44'	4.00	West	8.50	N15°44'	7.00
	N34°44'	4.50	N44°44'	5.00	N18°44'	16.00
	S29°44'	6.00	N36°44'	7.50	N44°44'	6.50
	S46°44'	6.50	N42°44'	7.50	N86°44'	6.50
	S55°44'	2.00	N9°44'	5.00	S42°44'	10.50
	S73°44'	4.47	N27°44'	1.50	S55°44'	8.00
3.	N81°44'	6.00	N27°44'	1.50	S77°44'	6.50
	N60°44'	11.50	N37°44'	3.00	S74°44'	4.70
	N77°44'	18.00	N37°44'	5.00	S48°44'	4.70
	N48°44'	4.50	N37°44'	5.00	N62°44'	10.00
	N23°44'	3.00	N27°44'	1.50	N74°44'	10.00
	N7°44'	4.50	N37°44'	3.00	S75°44'	3.50
	N11°44'	4.18	N37°44'	5.00	N70°44'	4.50
	N77°44'	4.00	N37°44'	5.00	N36°44'	6.00
	N38°44'	3.50	N37°44'	5.00	N15°44'	7.70
	N53°44'	9.00	West	2.50	N15°44'	4.50
	N88°44'	3.00	S43°44'	4.00	N31°44'	11.50
	S72°44'	3.00	S19°44'	9.00	N71°44'	7.00
	S54°44'	2.50	S1°44'	2.50	S76°44'	12.50
	N84°44'	7.00	S35°44'	5.00	N29°44'	7.00
	N31°44'	6.00	S77°44'	8.50	N83°44'	4.00
	S78°44'	1.50	S41°44'	6.50	S29°44'	5.00
	S7°44'	3.00	S31°44'	6.00	S16°44'	4.00
	S31°44'	6.00	S61°44'	3.50	S42°44'	10.50
	S23°44'	7.00	N76°44'	2.50	S48°44'	2.00
	S25°44'	2.20	N39°44'	4.00	S40°44'	2.50
6.	S36°44'	6.50	N6°44'	12.00	S26°44'	7.50
	S20°44'	3.84	N57°44'	3.50	S42°44'	5.50
	S27°44'	8.00	S63°44'	9.00	S61°44'	5.00
	N89°44'	4.00	S74°44'	5.00	N78°44'	4.00
	N42°44'	7.50	S62°44'	2.50	N26°44'	10.00
	N12°44'	5.00	S11°44'	10.60	N77°44'	14.00
	S74°44'	5.00	S60°44'	4.00	S72°44'	4.50
	N70°44'	3.50	S89°44'	3.50	N5°44'	4.20
	N19°44'	3.50	N71°44'	9.50	N19°44'	5.50
	N20°44'	3.44	S82°44'	3.00	N62°44'	7.00
9.	N1°44'	2.50	S24°44'	10.00	N28°44'	6.00
	N56°44'	10.50	N87°44'	25.50	N13°44'	8.00
	N8°44'	5.00	S57°44'	2.00	N16°44'	5.00
			S16°44'	3.50	N52°44'	5.00
			S34°44'	9.50	S50°44'	5.00
			S14°44'	5.00	S74°44'	7.00
			S30°44'	8.50	N83°44'	7.00

Total number of Acres 22,706.4

Surveys Designated	By Whom Surveyed	Date of Contract	Amount of Surveys	When Surveyed	When p ^d for and ch ^d in the Sur ^g Gen ^l acc ^t
Township lines	Sibley & Clark	27 th June 1833	M. ch ^d Lks. 24. 05. 42	1 st of 1834	2 nd of 1834
Subdivisions	Strick Biggs	21 st April 1834	75. 05. 30	1 st of 1835	3 rd of 1835

The above Map of Township No 33 North of Range No 6 W of the 2nd Principal Meridian Indiana is strictly conformable to the field notes of the survey thereof on file in this Office, which have been examined and approved.

Surveyor General's Office
Cincinnati April 21st 1835

Robt. J. Sutter
Sur. Genl.

by Saml Williams

IND

Annotated by Steven R. Shook, December 2013

