



Scanned From Records of  
 Porter County Surveyor's Office  
 155 Indiana Avenue Suite 303 Valparaiso, IN 46383  
 Phone (219) 465-3560

Kevin D. Breitzke, P.E., L.S. - Porter County Surveyor

Copyright © 2012 Porter County, IN. All Rights Reserved.  
 Disclaimer: The information of this drawing is believed to be reliable, but no representations, guarantees or warranties of any kind are made as to its accuracy, currency, revision, or suitability for particular applications.

*C. 385*

MAY OF  
 THE TOWN OF  
 BOONE GROVE.  
 Porter County Indiana  
 Scale 100 ft to the inch

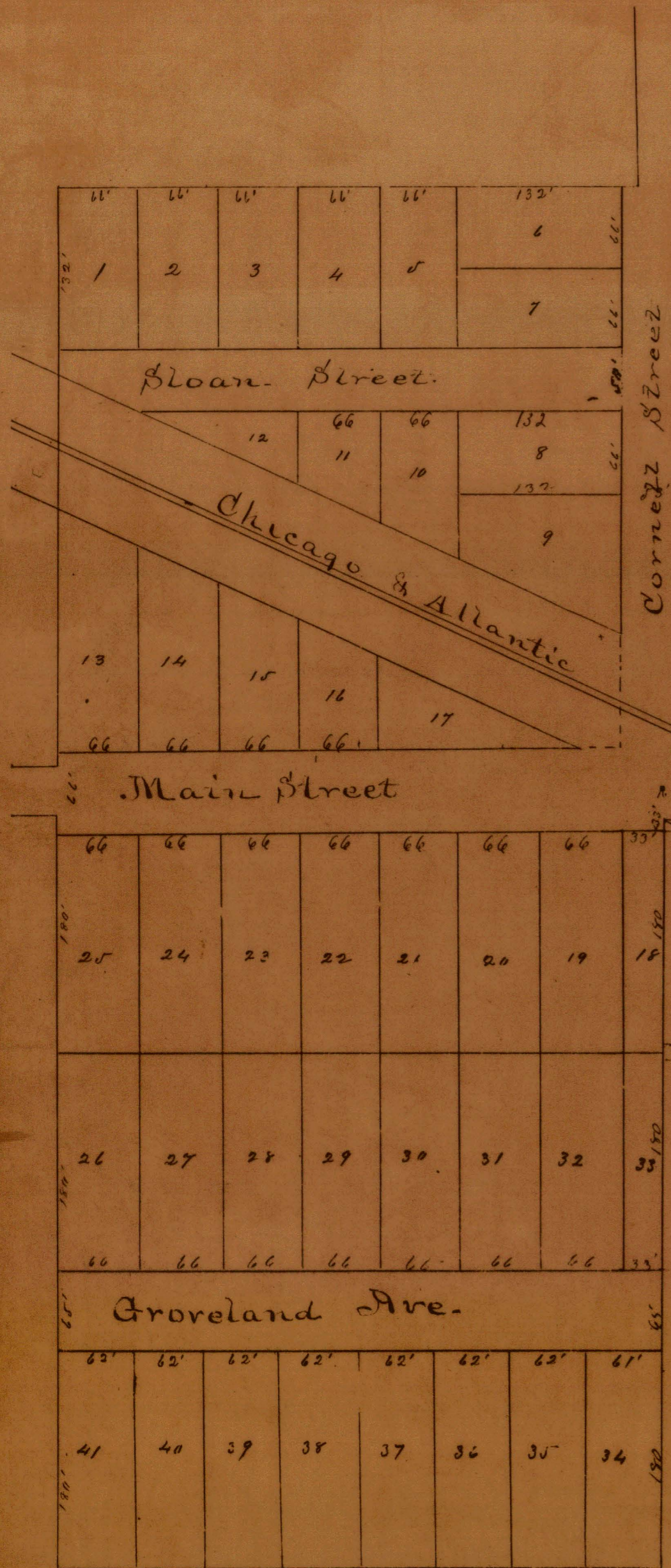

This is a Plat of the Town of Boone Grove Porter County Indiana located on the following described land to-wit: Commencing at the center of Section 32 Town 34 N. Range 6 E. Thence North 495 feet - Thence West 495 feet - Thence South 1133 feet - Thence East 495 feet - Thence North 638 feet to the place of beginning. The lots are numbered from one to forty one inclusive. The width of lots and streets are quarantined in feet on the Plat. In Witness Whereof I hereunto subscribe my name this 29<sup>th</sup> day of January 1883  
 E. A. Wilder

State of Indiana Porter County } ss Before me William C. Wells the Recorder in and for said County this 29<sup>th</sup> day of January 1883 E. A. Wilder acknowledged the execution of the within Plat of the Town of Boone Grove. Witness my hand and official seal  
 Recorded Feb'y 5<sup>th</sup> 1883 at 2 P.M.  
 William C. Wells Recorder

DRAWING NUMBER  
 BOONE GROVE  
 104512A1

DRAWING NUMBER  
 104-9